

Mitnehmerkupplungen

Kupplung Welle \varnothing 6 mm

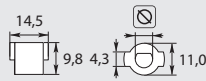

| | |
|---------|---------------|
| R+M Nr. | \varnothing |
| 822 30 | 6 mm |

Kupplung Welle \varnothing 8 mm kurz

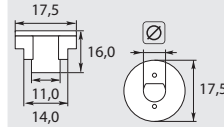

| | |
|---------|---------------|
| R+M Nr. | \varnothing |
| 822 25 | 8 mm |

Kupplung Welle \varnothing 8 mm lang

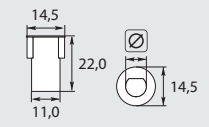

| | |
|---------|---------------|
| R+M Nr. | \varnothing |
| 822 35 | 8 mm |

Ölmagnetventile

Rapa BV 01 ohne Kabel



Stromlos geschlossen. Max. 24 bar / 60 °C

| | | |
|---------|---------|-------|
| R+M Nr. | \odot | Spule |
| 830 10 | 1/8" IG | 24 V |
| 830 20 | 1/8" IG | 230 V |
| 830 40 | 1/4" IG | 230 V |

Brennermotoren

Pumpenaufnahme 32 mm

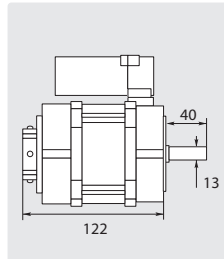

Leistung max. 150 W - 1,3 A. Kabel 500 mm.
Drehrichtung rechts oder links

| | |
|---------|----------|
| R+M Nr. | ∇ |
| 811 03 | 230 V |

Flansch für Brennermotoren

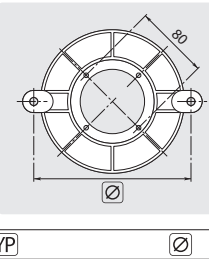

| | | |
|---------|--------|---------------|
| R+M Nr. | TYP | \varnothing |
| 811 01 | NEMA 1 | 172 mm |
| 811 02 | NEMA 2 | 184 mm |

Ersatzspule Rapa



| | |
|---------|----------|
| R+M Nr. | ∇ |
| 830 70 | 230 V |

Kabel mit Stecker



| | |
|---------|--------------------|
| R+M Nr. | \rightleftarrows |
| 832 40 | 1.050 mm |

Flansch und Pumpenaufnahme 32 mm

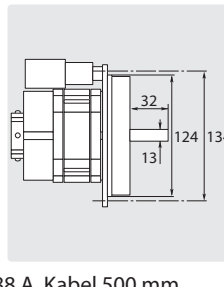

Leistung max. 110 W - 0,88 A. Kabel 500 mm.
Drehrichtung links

| | |
|---------|----------|
| R+M Nr. | ∇ |
| 810 00 | 230 V |

Elektrische Verbindungen für 5-polige Brennermotoren

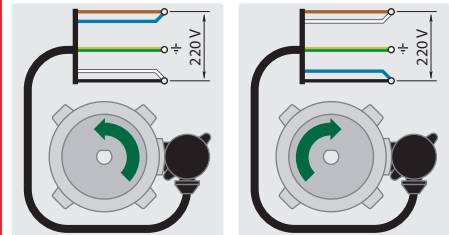

Linkslaufend

Rechtslaufend

| C | Funktion | C | Funktion |
|--------------|----------|--------------|----------|
| braun+blau | Phase | braun+weiß | Phase |
| schwarz+weiß | Null | schwarz+blau | Null |
| gelb/grün | Erde | gelb/grün | Erde |

Ölfilter

Leitungsölfilter

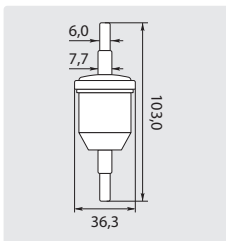

| |
|---------|
| R+M Nr. |
| 829 05 |

Symbole \varnothing Durchmesser TYP Typ ∇ Volt \odot Gewinde \rightleftarrows Länge C Farbe